



GUILDFORD
BOROUGH

www.guildford.gov.uk

Tom Horwood
Joint Chief Executive of Guildford and
Waverley Borough Councils

Dear Councillor

PLANNING COMMITTEE - WEDNESDAY 8 NOVEMBER 2023

Please find attached the following:

Agenda No Item

8. **Presentation (Pages 1 - 22)**

Yours sincerely

Sophie Butcher, Democratic Services Officer

Encs

This page is intentionally left blank

23/P/00679

**Garages, land to the rear of
Bishopsmead Parade
East Horsley
KT24**

[Previous](#)

[Next](#)

[Home](#)

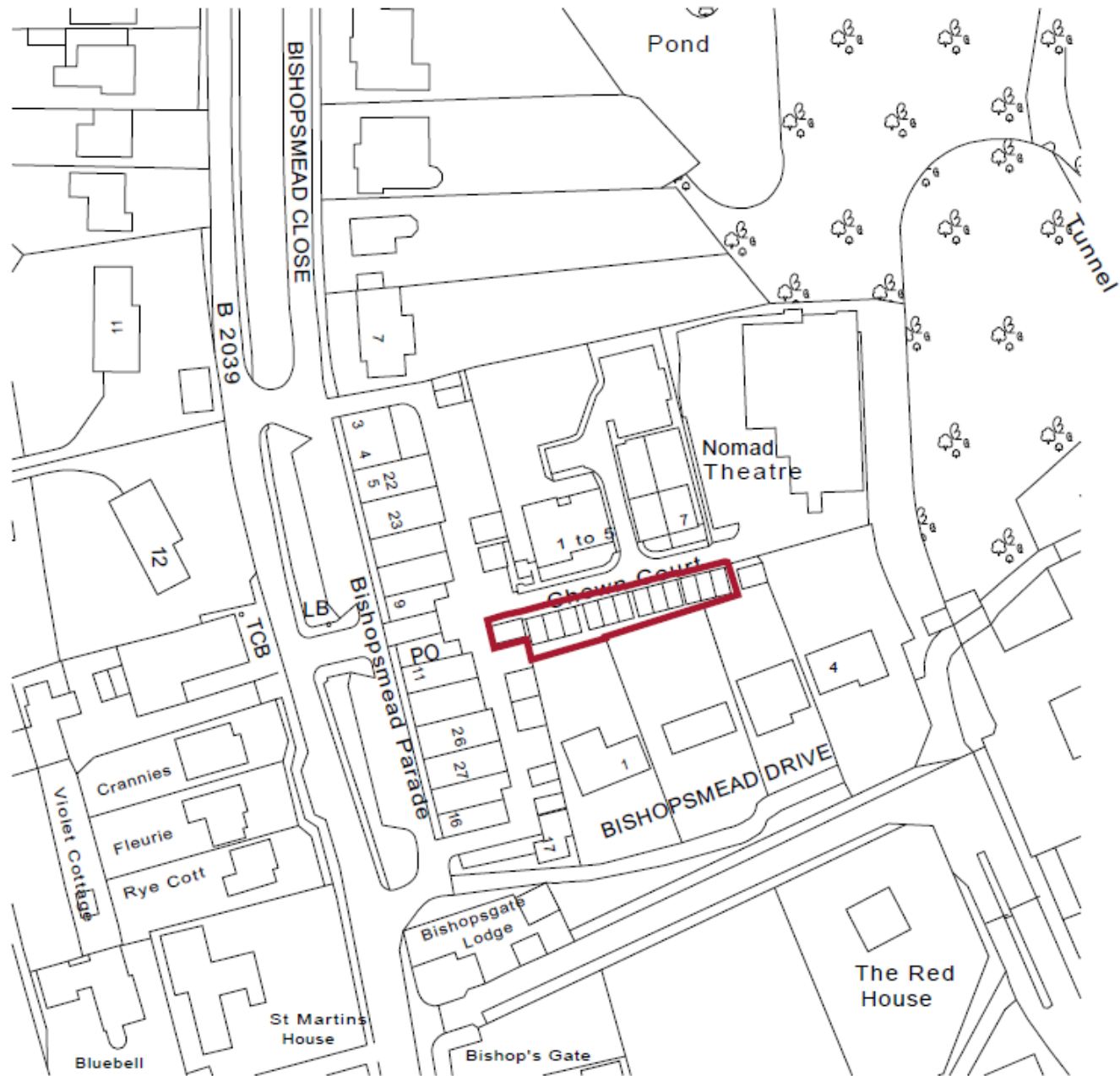

Site location plan

[Previous](#)

[Next](#)

[Home](#)



key:  Grade B/C trees  Grade C trees  Root Protection Areas

Existing Site location Plan

[Previous](#)

[Next](#)

[Home](#)



key:  Grade B/C trees  Grade C trees  Root Protection Areas

Proposed site layout

[Previous](#)

[Next](#)

[Home](#)



Proposed north (front) elevation

[Previous](#)

[Next](#)

[Home](#)



Proposed west (side) elevation

[Previous](#)

[Next](#)

[Home](#)



Proposed east (side) elevation

[Previous](#)

[Next](#)

[Home](#)



Proposed south (rear) elevation

[Previous](#)

[Next](#)

[Home](#)

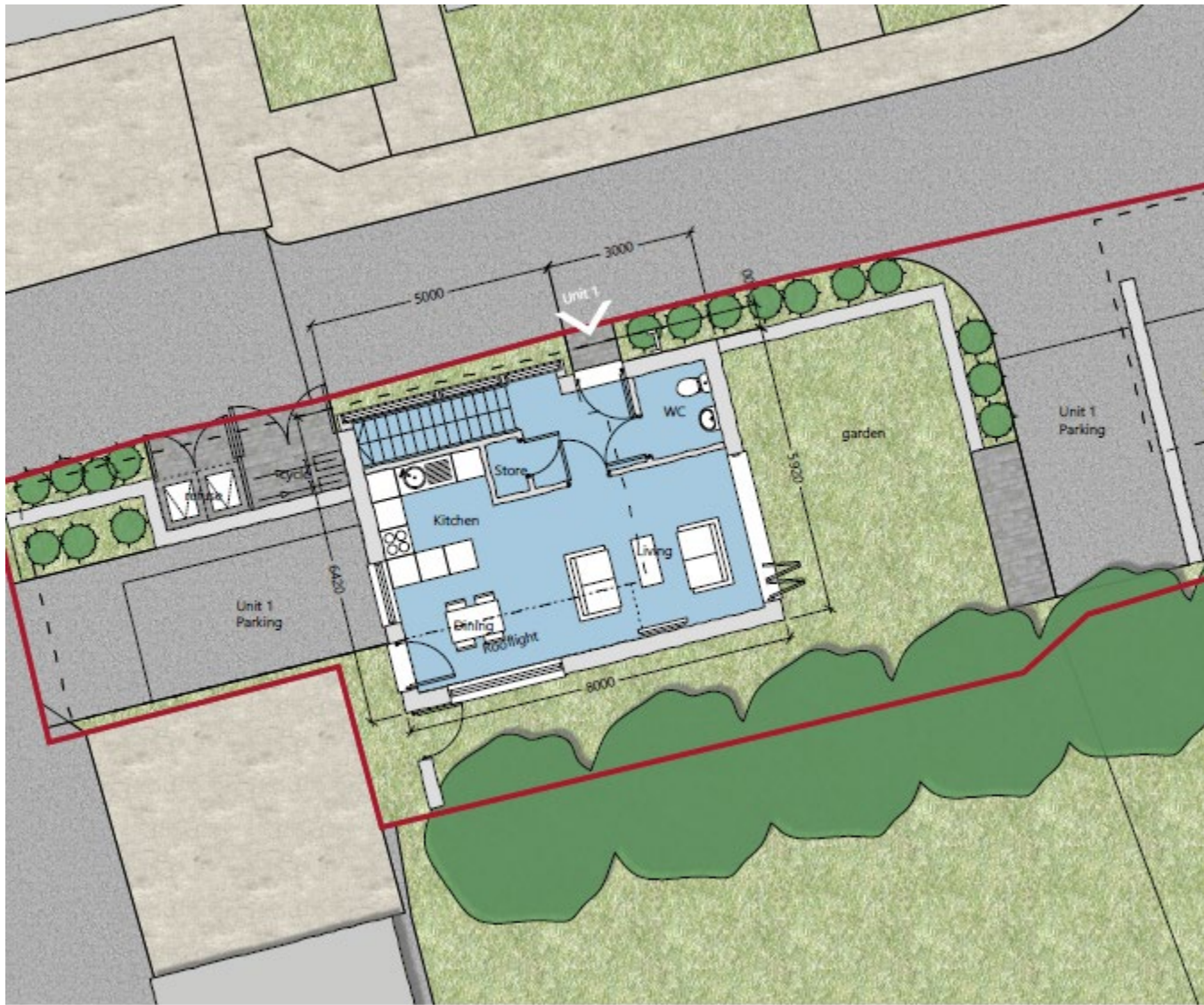

Unit 1 ground floor plan

[Previous](#)

[Next](#)

[Home](#)

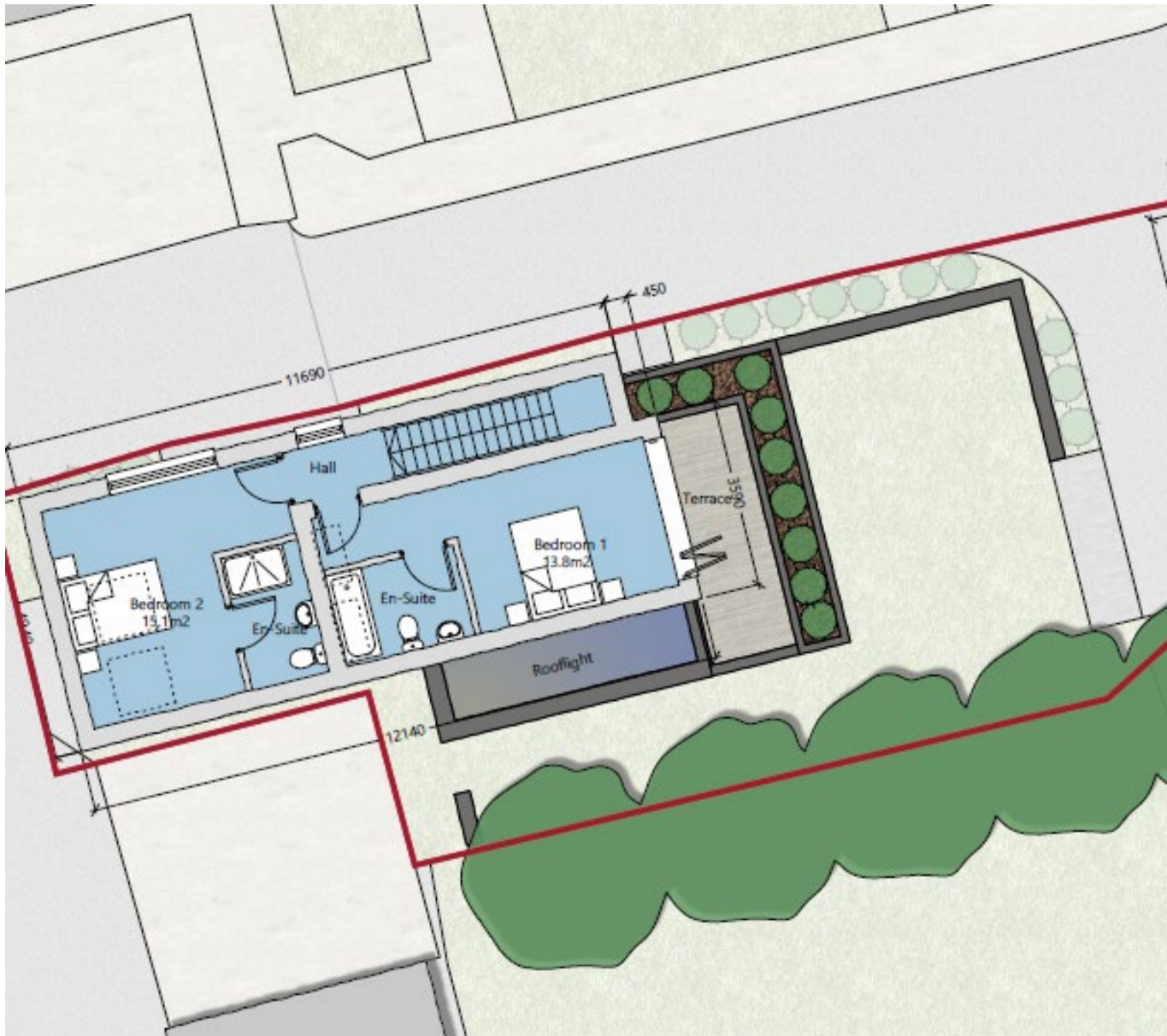

Unit 1 first floor plan

[Previous](#)

[Next](#)

[Home](#)

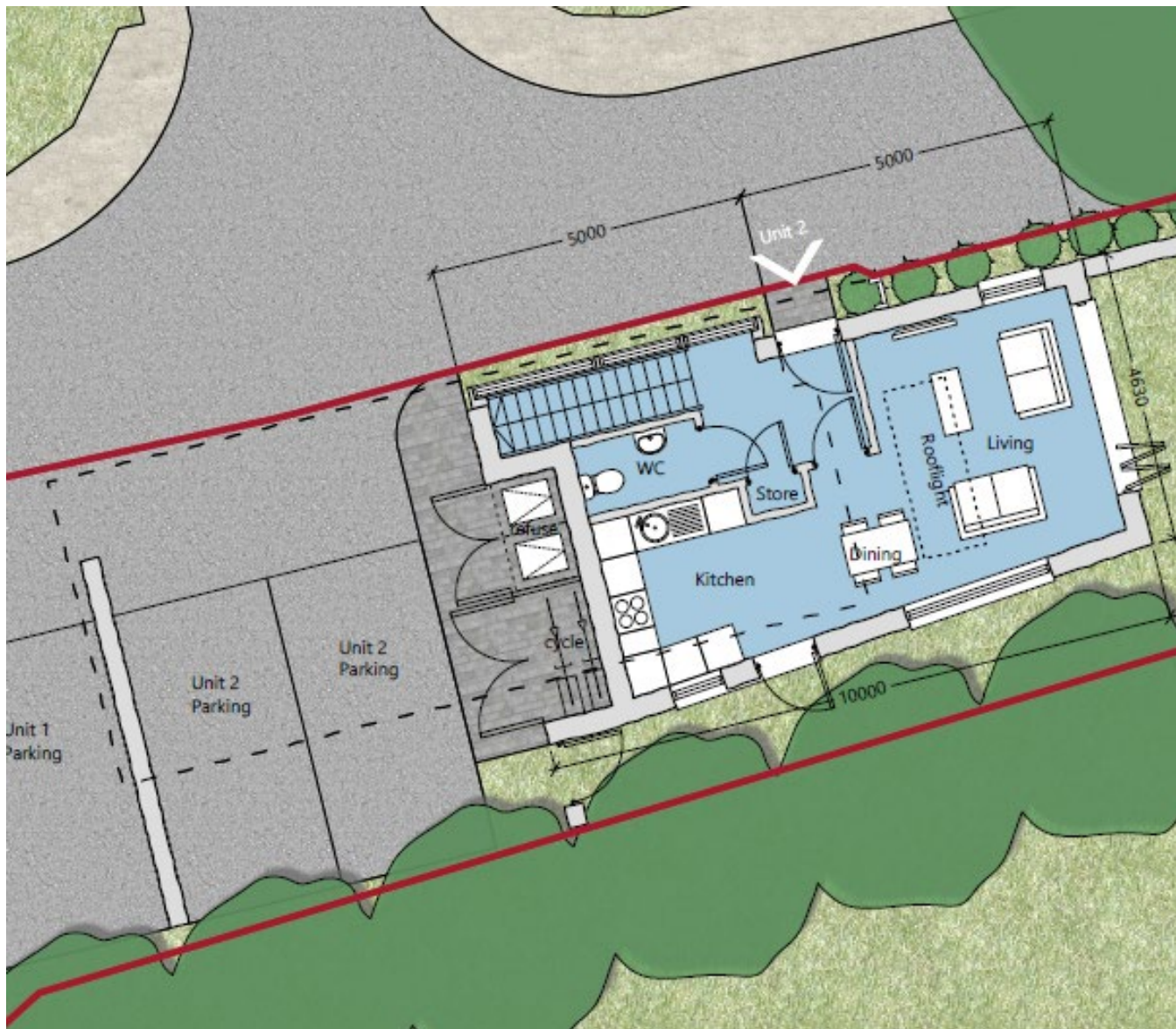

Unit 2 ground floor plan

[Previous](#)

[Next](#)

[Home](#)

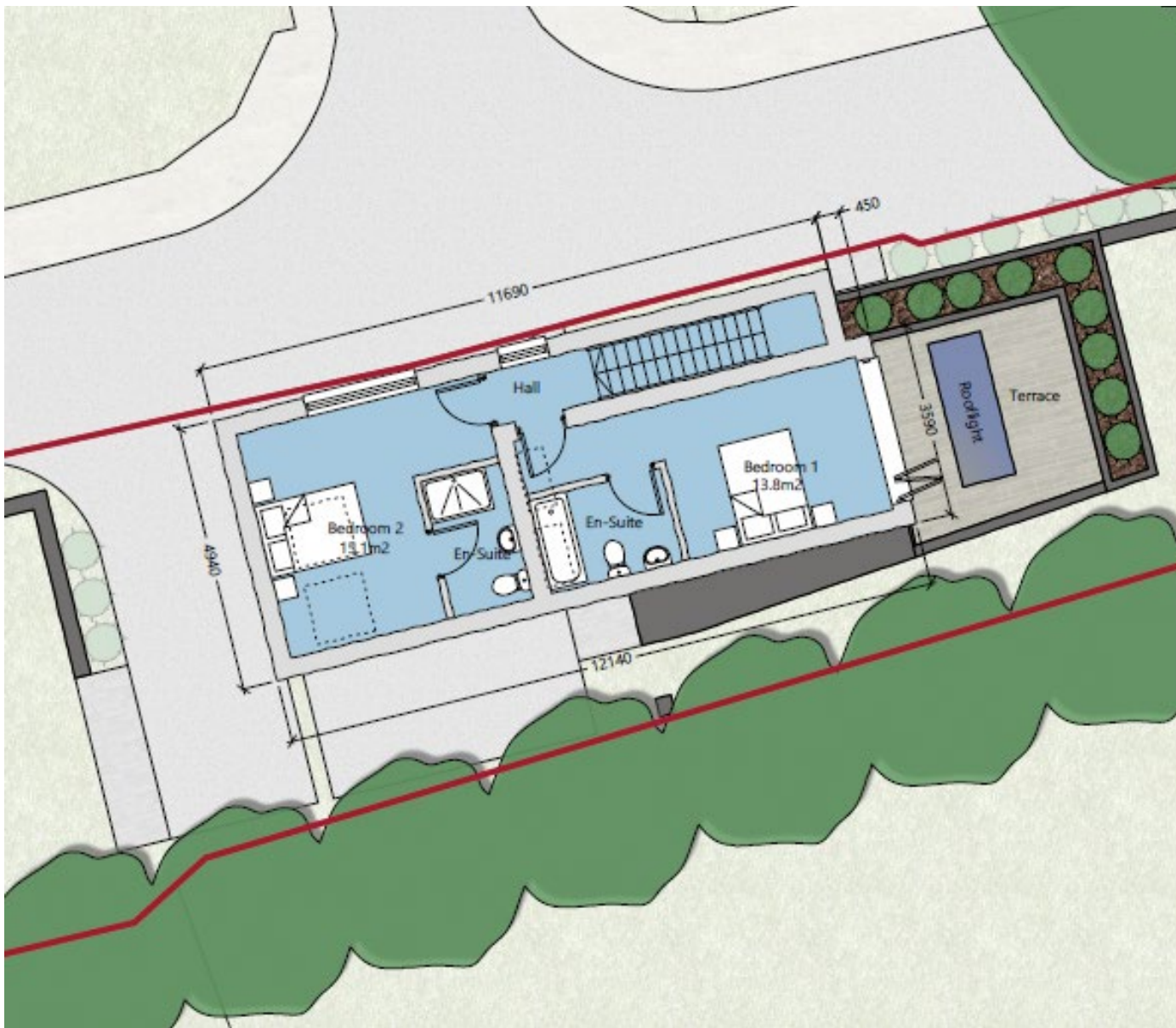

Unit 2 first floor plan



Proposed roof plan

[Previous](#)

[Next](#)

[Home](#)



Existing Site Section



Proposed Site Section

Proposed existing and proposed streetscene

[Previous](#)

[Next](#)

[Home](#)

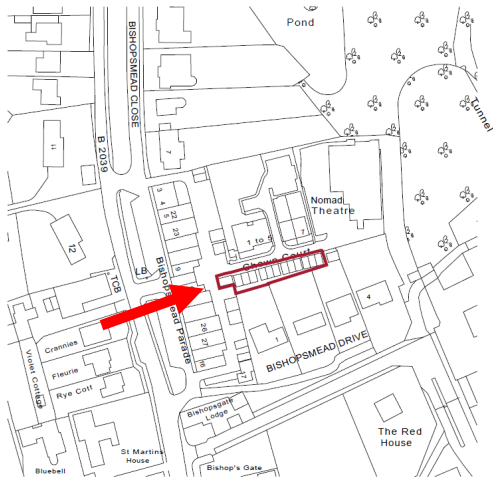

View looking down access

[Previous](#)

[Next](#)

[Home](#)



View of existing garages, looking towards rear of Bishopsmead Parade shops

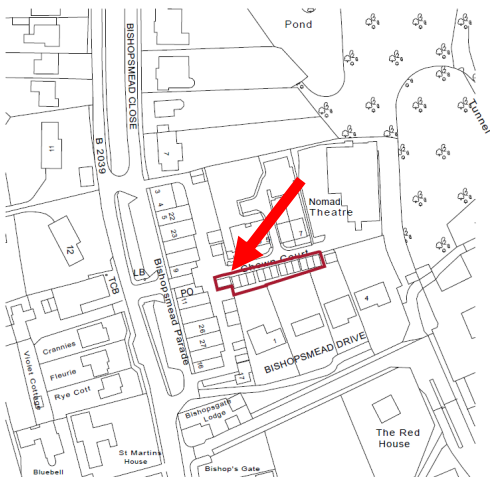

[Previous](#)

[Next](#)

[Home](#)

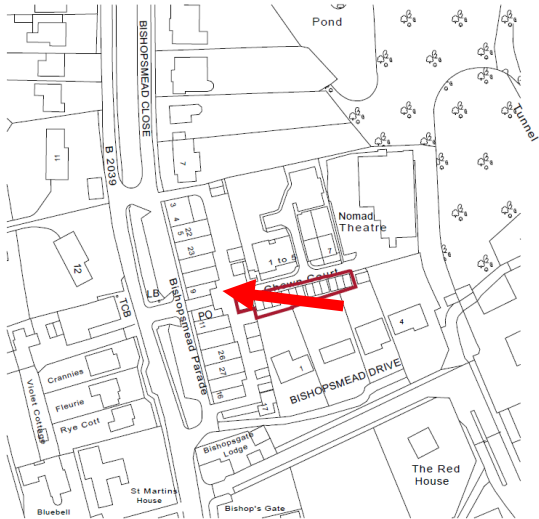

View looking towards rear of Bishopsmead Parade shops

[Previous](#)

[Next](#)

[Home](#)

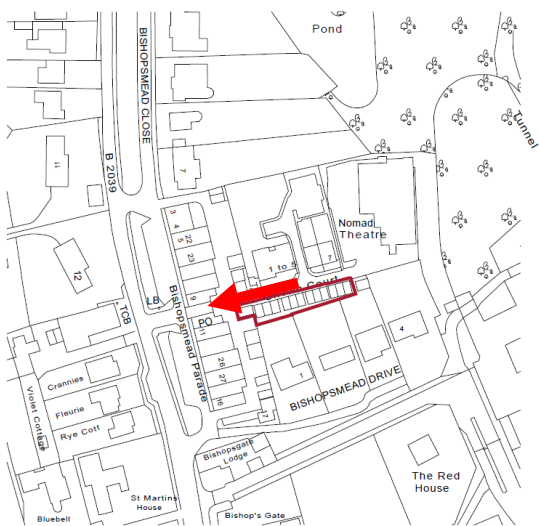

Access into/out of site

[Previous](#)

[Next](#)

[Home](#)

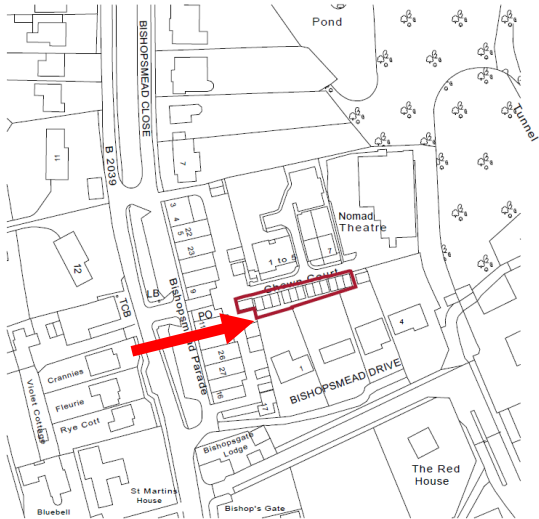

Rear of garages

[Previous](#)

[Next](#)

[Home](#)

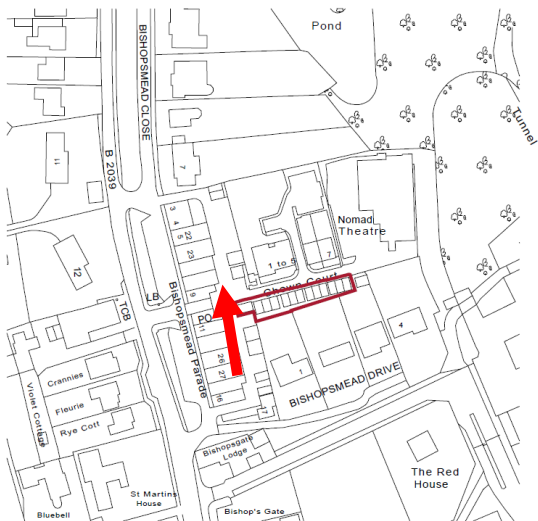

Rear of Bishopsmead Parade shops

[Previous](#)

[Next](#)

[Home](#)



key:  Grade B/C trees  Grade C trees  Root Protection Areas

Proposed site layout

[Previous](#)

[Next](#)

[Home](#)

This page is intentionally left blank